

**COMBINED PREMIUM LIST  
BULLDOG CLUB OF INDIANA  
SPECIALTY SHOWS  
MARCH 12 & 13, 2022**

**Entries close on Wednesday, February 23, 2022 at 12pm EST**



**3 Specialty Shows, 1 Sweepstakes, plus Puppy Match held by:**

**Bulldog Club of Indiana, Inc.**

(Indoors & Unbenched, Licensed by the American Kennel Club)  
(No Obedience or Junior Showmanship classes offered)

**Saturday am, March 12, 2022**

Event #2022139301

**Saturday pm, March 12, 2022**

Event #2022139303

**Sunday am, March 13, 2022**

Event #2022139302

**All 3 Shows will be held at The Boone County 4-H  
Fairgrounds - Farm Bureau Community Auditorium Bldg.**

**AMERICAN KENNEL CLUB CERTIFICATION**  
Permission is granted by the American Kennel Club for holding of  
this event under American Kennel Club rules and regulations.  
James P. Crowley, Secretary



**Bulldog Club of Indiana**  
Jodi Madaj, Secretary  
5501 Travis Road  
Greenwood, IN 46143

First Class

**Dated Material  
Premium List Enclosed**

## Judges

Saturday am, March 12, Sweepstakes

**Ms. Kara Gordon**

Conroe, TX 77384

Saturday am, March 12, 2022– BCI

**Mr. Mark Kennedy # 1191**

Murraysville, PA 15668

Saturday pm, March 12, 2022 – BCI

**Mrs. Roxanne Williamson # 98028**

Hartley, IA 51346

Sunday am March 13, 2022 - BCI

**Ms. Diana Engeszer # 95607**

St. Louis, Mo 63116

---

---

## **Show Hours**

**Saturday am show, 9:00 A.M. to 1:00 P.M. EST**

**Saturday pm show, 2:00 P.M. to 5:00 P.M.**

**Saturday Puppy Match, 30 min after PM show**

**Sunday show, 9:00 A.M. to 12:00 P.M. EST**

Dogs are not required to be at the show until scheduled time of judging.

All dogs not needed for further judging will be excused.

**Show Location will be available to Exhibitors by Saturday 7am, March 12th.**

**The showroom will be locked each day, 1 hour after conclusion of all judging.**

Boone County 4-H Fairgrounds

1300 E 100 South

Lebanon, Indiana 46241

Directions: Fairgrounds are north of Indianapolis on I-65. Take exit 139

### **Show Photographer**

Brook Nugent  
W6519 State Hwy 144  
Random Lake, WI 53075  
brooknugent.com

### **Show Veterinarian - Open 24 hours**

Airport Animal Emergi-Center  
5235 W. Washington St.  
Indianapolis, IN 46241  
(317) 248-0832

**Vet Directions:** I-65 south towards Indianapolis. Keep right, turns into 465. Get off at Exit 12/Washington St. Turn left onto E Washington. Travel 1 mile to Airport Animal Emergi-Center.

## **LOCAL LODGING OPTIONS**

**Use Promo Code: BCI/Bulldog Club of Indiana**

### **America's Best Value Inn**

1280 W SR 32, Lebanon, IN 46052  
Ph. (765) 482-9190

### **Econo Lodge**

1245 W SR 32, Lebanon, IN 46052  
Ph. (765) 482-9611

### **Motel 6**

405 N. Mt. Zion Road, Lebanon, IN 46052  
Ph. (765) 482-9999

### **Quality Inn & Suites**

210 Sam Ralston Road, Lebanon, IN 46052  
Ph. (765) 482-4800

### **WoodSpring Suites**

Zionsville 6007 Perry Worth Rd. Whitestown, IN 46075  
Ph. (317) 732-0517

*Other hotels/motels may be available in area  
Check online for more options*

- IN ACCORDANCE WITH CHAPTER 11, SEC. 11, AKC RULES APPLYING TO DOG SHOWS: "Only dogs that are eligible to be shown under The American Kennel Club Rules shall be allowed within the show precincts. There shall be no benching, nor offering for sale or breeding, nor any displaying of un-entered dogs." The show-giving clubs will strictly enforce the above-stated rule. Violators will be subject to action by the Event Committee and if found in violation, suspension of AKC privileges may be recommended
- GROOMING dogs in areas other than as designated is not permitted. This will be strictly enforced.
- ANY CASH PRIZES will be made in the ring before the judging of the breed is over and the Show Secretary is advised at once. The Secretary and Show-giving clubs disclaim any liability for cash prizes after the judging of the breed is over.
- ALL TROPHIES MUST BE CLAIMED the day of the show. Any unclaimed trophies will revert to the BCI general trophy fund after the showing of the breed.
- No dogs or food bowls in restrooms. Persons found violating this rule are subject to action by the Event Committee.
- Handicapped facilities are available.
- Please obey all posted signs. Exhibitors must be governed by any rules or regulations of civil authorities. **ALL EXHIBITORS MUST HELP** to maintain this site by assisting in keeping it in excellent condition.
- **ALL EXHIBITORS ARE CHARGED** with the responsibility of cleaning in and around their rooms, vehicles, crates and dogs. Please clean after your dog(s) immediately. Please dispose of all garbage in proper containers.

**ATTENTION:** Incoming calls on cellular telephones are not allowed ringside as it interrupts judging and distracts the dogs and exhibitors.

The BCI reserves the right to substitute a prize. All trophies/prizes must be claimed the day of the show.

The Bulldog Club of America, The Bulldog Club of Indiana, Inc., Boone County 4-H Fairgrounds, the Show Superintendent, their agents, employees, etc, assume no responsibility for any loss, damage or injury sustained by exhibitors, handlers, or to any of their dogs or property and further assume no responsibility for injury to children.

**Show Site is the Boone County 4-H Fairgrounds  
Farm Bureau Community Auditorium Bldg.  
1300 E 100 South, Lebanon, IN 46062**

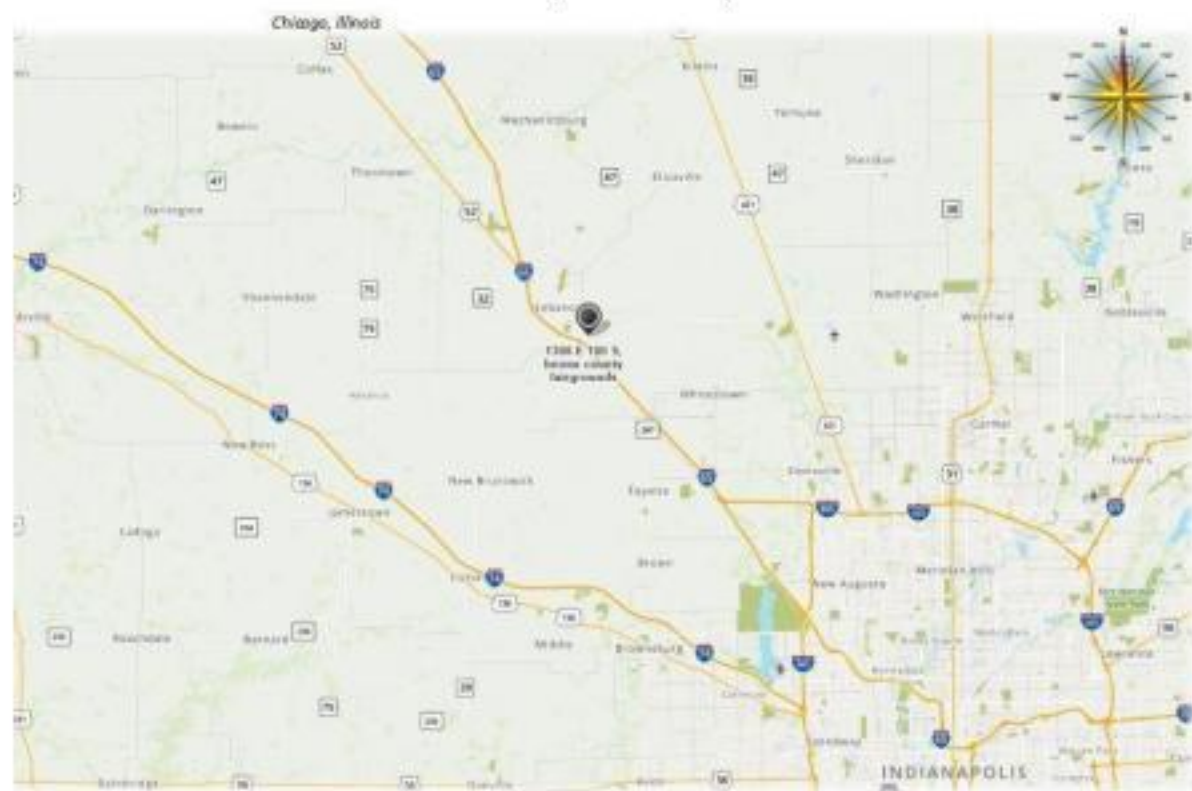

## Classifications

The following classes will be provided for both dogs and bitches and applies to all shows:

### REGULAR CLASSES

- Puppy, 6 months and under 9 months
- Puppy, 9 months and under 12 months
- Junior, 12 months and under 18 months
- Bred by Exhibitor
- American Bred
- Open
- Winners
- Best of Breed

#### **Bred By Exhibitor class eligibility**

All dogs entered in the Bred By Exhibitor Class must be individually registered with the AKC. The person handling the dog must be a breeder of record of the dog, and an owner of record of the dog. To exhibit in this class, family members must be a breeder and owner of record.

### SWEEPSTAKES

The sweepstakes will begin at 9:00 a.m. Saturday, March 12, 2022 and is open to any registered AKC Bulldog, at least six (6) months and under 18 months of age on the date of the show. No Champions are eligible, however, dogs holding major wins may compete.

**All entries in Sweepstakes MUST be entered in Saturday's regular class.**

Entries must be made at the same time as entries for the regular class on the same form with the word Sweepstakes marked in the Additional Class box. The Sweepstakes entry fee due is \$20.00.

*The following Sweepstake classes will be provided for both dogs & bitches:*

- 6 months and under 9 months
- 9 months and under 12 months
- 12 months and under 18 months
- Best In Sweepstakes
- Best Of Opposite Sex In Sweepstakes

# Ribbons ~ Prizes ~ Sweepstakes

## RIBBONS

### BEST OF BREED COMPETITION

First Prize .....	Blue Ribbon
Second Prize .....	Red Ribbon
Third Prize .....	Yellow Ribbon
Fourth Prize .....	White Ribbon
Winners .....	Purple Rosette
Reserve Winners .....	Purple & White Rosette
Best of Winners .....	Blue & White Rosette
Best of Opposite Sex to Best of Breed .....	Red & White Rosette
Select Bitch / Select Dog .....	Lt. Blue & White Ribbon
Best of Breed .....	Purple & Gold Rosette

## SWEEPSTAKES

First Prize .....	Rose Ribbon
Second Prize .....	Brown Ribbon
Third Prize .....	Light Green Ribbon
Fourth Prize .....	Gray Ribbon
Best in Sweepstakes .....	Pink & Green Rosette
Best of Opposite Sex to Best in Sweepstakes .....	Lavender Rosette

## PRIZES AND TROPHIES

This is a condensed form of the Premium List, as provided for in Chapter 6, Section 2A of The American Kennel Club "Rules Applying to Registration and Dog Shows." A list of Breed and Sweepstakes prizes and trophies for all shows will be included in the Show Catalog. You may also obtain a list by writing to the Show Secretary after the closing date for the shows. Please include a self-addressed stamped envelope with your request.

## SWEEPSTAKES PRIZE MONEY

The Club will retain 50% of the Sweepstakes money for expenses and the other 50% will comprise the prize money. In each age and sex division the prize money will be divided as follows: First Prize - 40%, Second Prize - 30%, Third Prize - 20%, Fourth Prize - 10%

## AGREEMENT

I (we) agree club holding this event has the right to refuse this entry for cause which the club shall deem sufficient. In consideration of the acceptance of this entry and of the holding of this event and of the opportunity to have the dog judged and to win prizes, ribbons, or trophies, I (we) agree to hold the AKC, the event-giving club, their members, directors, governors, officers, agents, superintendents or event secretary and the owner and/or lessor of the premises and any provider of services that are necessary to hold this event and any employees or volunteers of the aforementioned parties, and any AKC approved judge, judging at this event, harmless from any claim for loss or injury which may be alleged to have been caused directly or indirectly to any person or thing by the act of this dog while in or about the event premises or grounds or near any entrance thereto, and I (we) personally assume all responsibility and liability for any such claim; and I (we) further agree to hold the aforementioned parties harmless from any claim for loss, injury or damage to this dog. Additionally, I (we) hereby assume the sole responsibility for and agree to indemnify, defend and save the aforementioned parties harmless from any and all loss and expense (including legal fees) by reason of the liability imposed by law upon any of the aforementioned parties for damage because of bodily injuries, including death at any time resulting therefrom, sustained by any person or persons, including myself (ourselves), or on account of damage to property, arising out of or in consequence of my (our) participation in this event, however such injuries, death or property damage may be caused, and whether or not the same may have been caused or may be alleged to have been caused by the negligence of the aforementioned parties or any of their employees, agents, or any other persons. **I (WE) AGREE THAT ANY CAUSE OF ACTION, CONTROVERSY OR CLAIM ARISING OUT OF OR RELATED TO THE ENTRY, EXHIBITION OR ATTENDANCE AT THE EVENT BETWEEN THE AKC AND THE EVENT-GIVING CLUB (UNLESS OTHERWISE STATED IN ITS PREMIUM LIST) AND MYSELF (OURSELVES) OR AS TO THE CONSTRUCTION, INTERPRETATION AND EFFECT OF THIS AGREEMENT SHALL BE SETTLED BY ARBITRATION PURSUANT TO THE APPLICABLE RULES OF THE AMERICAN ARBITRATION ASSOCIATION. HOWEVER, PRIOR TO ARBITRATION ALL APPLICABLE AKC BYLAWS, RULES, REGULATIONS AND PROCEDURES MUST FIRST BE FOLLOWED AS SET FORTH IN THE AKC CHARTER AND BYLAWS, RULES, REGULATIONS, PUBLISHED POLICIES AND GUIDELINES.**

## INSTRUCTIONS

1. (Variety) if you are entering a dog of breed in which there are varieties for show purposes, please designate the particular variety you are entering, i.e., Cocker Spaniel (solid color black, ASCOB, parti-color), Beagles (not exceeding 13 in., over 13 in. but not exceeding 15 in.), Dachshunds (longhaired, smooth, wirehaired), Collies (rough, smooth), Bull Terriers (colored, white), Manchester Terriers (standard, toy), Chihuahuas (smooth coat, long coat), English Toy Spaniels (King Charles and Ruby, Blenheim and Prince Charles), Poodles (toy, miniature, standard).
2. The following categories of dogs may be entered and shown in Best of Breed competition: Dogs that are Champions of Record and dogs which, according to their owners' records, have completed the requirements for a championship, but whose championships are unconfirmed. The showing of unconfirmed Champions in Best of Breed competition is limited to a period of 90 days from the date of the show where the dog completed the requirements for a championship.
3. (Event Class) Consult the classification in this premium list. If the event class in which you are entering your dog is divided, then, in addition to designating the class, specify the particular division of the class in which you are entering your dog, i.e. age division, color division, weight division.
4. A dog must be entered in the name of the person who actually owned it at the time entries for an event closed. If a registered dog has been acquired by a new owner it must be entered in the name of its new owner in any event for which entries closed after the date of acquirement, regardless of whether the new owner has received the registration certificate indicating that the dog is recorded in his name. State on entry form whether transfer application has been mailed to the AKC. (For complete rules, refer to Chapter 11, Section 3.)
5. Mixed breed dogs entering classes for Agility, Obedience, and Rally trials should mark Breed as "All-American Dog/ Mixed Breed" Sire and Dam information shall remain blank for mixed breed entrants.

If this entry is for Junior Showmanship, please give the following information:

JUNIOR SHOWMANSHIP  
JR.'S DATE OF BIRTH

AKC JUNIOR HANDLER NUMBER

*Not Offered*

The above number MUST be included. Should you not have your Junior Handler number, this may be obtained from the American Kennel Club. Phone: (919) 233-9767.

**By signing the entry form I (we) certify that the Junior Showman does not now, and will not at any time, act as an agent/handler for pay while continuing to compete in Junior Showmanship.**

ADDRESS \_\_\_\_\_

CITY \_\_\_\_\_ STATE \_\_\_\_\_ ZIP \_\_\_\_\_



AMERICAN KENNEL CLUB™

Online entries may be made via Club's website www.bulldogclubindiana.com

OFFICIAL ENTRY FORM

- ( ) BULLDOG CLUB of INDIANA, Specialty Show-3/12/22 Event # 2022139301
( ) BULLDOG CLUB of INDIANA, Sweepstakes - 3/12/22 Event # 2022139301
( ) BULLDOG CLUB of INDIANA, Specialty - 3/12/22 Event # 2022139303
( ) BULLDOG CLUB of INDIANA, Specialty Show- 3/13/22 Event # 2022139302

I ENCLOSE \$ for entry fees

Form fields: BREED (Bulldog), VARIETY, SEX, DOG SHOW CLASS, ADDITIONAL CLASSES, OBEDIENCE CLASS, JR. SHOWMANSHIP CLASS, NAME OF JUNIOR HANDLER, JR. HANDLER NUMBER, FULL NAME OF DOG

Form fields: AKC NO., PAL/PL NO., FOREIGN REG NO. & COUNTRY, DATE OF BIRTH

Form fields: BREEDER, SIRE, DAM

Form fields: ACTUAL OWNER(S), OWNER'S ADDRESS, CITY, STATE, ZIP

Form field: NAME OF OWNER'S AGENT (IF ANY) AT THE SHOW

I CERTIFY that I am the actual owner of the dog, or that I am the duly authorized agent of the actual owner whose name I have entered above. In consideration of the acceptance of this entry, I (we) agree to abide by the rules and regulations of the American Kennel Club in effect at the time of this event...

SIGNATURE of owner or his/her agent Duly authorized to make this entry

Form fields: TELEPHONE #, EMAIL (An Acknowledgement or receipt of entry may be sent to this email address)

Are you a new exhibitor? YES NO

Owner/Handler Eligible? YES NO

HOOSIER HOSPITALITY

Join us for good food & good company

Saturday morning - Breakfast

Saturday afternoon - Lunch

Provided by:

Sheriff Bob's Outlaw Pit BBQ Lafayette, Indiana

Sunday - Breakfast

Raffle Table / 50-50 / Silent Auction

Saturday Evening Puppy Match

Puppy Match Judge - Mr. Charlie Neese

The Bulldog Club of Indiana will hold a Puppy Match at the Boone County Fairgrounds show site. Registration will be all day Saturday, until the conclusion of the Saturday pm Specialty. Start time for the Puppy Match is 30 minutes after the pm show is over. Entry fee will be \$5.00. Use a standard AKC entry form.

Classes available to enter, with separate classes for dogs and bitches, will be:

- 3-4 month
4-6 month
6-9 month
9-12 month
Best Litter

ABSOLUTELY NO DOGS ALLOWED IN SHOWROOM OVERNIGHT!!



# Bulldog Club of America, Division II

## OFFICERS

PRESIDENT ..... Cathy Eke  
 VICE PRESIDENT ..... Kelley Ensminger  
 TREASURER ..... Chris Selle  
 SECRETARY ..... Julie Kuznieski

## GOVERNORS

Julie Abell, Ric Brown, Liz Karshner, Doris Leatherman, Wendell Tinsley

## COUNCILORS

Rachel Garde, Anita Hayes, Robert Krumwied, Robin Russell



# Bulldog Club of Indiana

## OFFICERS

PRESIDENT ..... Jeff Bennett  
 1st VICE PRESIDENT ..... Thomas Plake  
 2nd VICE PRESIDENT ..... April Paulman  
 TREASURER ..... Charlie Neese  
 SECRETARY ..... Jodi Madaj

## BOARD OF DIRECTORS

Cameron Madaj, Heidi Plake, Jennifer Sanders, Alicia Schwipps, Kyle Schwipps

## SHOW COMMITTEES

**Show Chairperson - Jeff Bennett**

481 Cormorant Court, Lafayette, IN 47909 - (765) 426-8878

**Show Secretary- Jodi Madaj**

5501 Travis Road, Greenwood, IN 46143 - (317) 432-2149

Hospitality - All Club Members

Ring Steward - Ms. Kara Gordon

## IMPORTANT - NOTICE TO EXHIBITORS - READ CAREFULLY

**ENTRY FEES** (includes \$0.50 recording fee and \$3.00 event service fee): \$30 for first entry of each dog, \$30 for 2nd entry of same dog on same day, except Sweepstakes entries which are \$20.00, Sweepstakes entries must be entered in a regular class.

- A RECORDING FEE of \$0.50 will be required for each dog entered at any Licensed or Member Club Show, Obedience Trial or Tracking Test. This Recording Fee will be collected by the Clubs and paid to the American Kennel Club. If a dog is entered in more than one class in the show, the Recording Fee is to be collected on the first entry only (Chapter 11, Sec. 2, AKC Rules).
- CLOSING DATE is Wednesday, FEBRUARY 20, 2019 at 12:00PM [EST], after which time entries cannot be accepted, canceled or substituted except as provided for in Chapter 11, Section 6 of the Dog Show Rules.
- TELEPHONE, TELEGRAPH, FACSIMILE and UNSIGNED ENTRIES FROM EXHIBITORS CANNOT BE ACCEPTED BY THE SHOW SECRETARY'S OFFICE.
- ENTRIES NOT ON OFFICIAL AKC ENTRY FORMS and PHOTOCOPIES OF ENTRY FORMS without the Agreement and Rules on the reverse side of Official AKC entry forms are NOT ACCEPTABLE.
- MAIL ENTRIES WITH FEES TO: Jodi Madaj- Show Secretary, 5501 Travis Rd., Greenwood, IN 46143 email - [MADAJ4@aol.com](mailto:MADAJ4@aol.com)
- OVERNIGHT ENTRIES TO: 5501 Travis Rd., Greenwood, IN 46143.
- ENTRIES RECEIVED WITHOUT FEES WILL NOT BE ACCEPTED. NO ENTRY SHALL BE MADE AND NO ENTRY SHALL BE ACCEPTED WHICH SPECIFIES ANY CONDITIONS AS TO ITS ACCEPTANCE. If sending entry by Express, Overnight or other special delivery, please release signature on recipient's end
- ONLINE ENTRIES may be made from the Club's website, with fee payment thru PayPal. [www.bulldogclubindiana.com](http://www.bulldogclubindiana.com)
- ENTRY FEE WILL NOT BE REFUNDED in the event that a dog is absent, disqualified, excused by veterinarian or judge, or barred from competition by action of Event Committee. If because of riots, civil disturbances or other acts beyond the control of the management it is impossible to open or to complete the show, no refund of entry fee will be made.
- MAKE ALL CHECKS & MONEY ORDERS payable to: The BULLDOG CLUB OF INDIANA Foreign exhibitors must make fees payable in U.S. FUNDS. SHOW SECRETARY assumes NO responsibility for cash sent through the mail.
- ERRORS ON ENTRY FORMS. Owners are responsible for errors in making out entry forms, or whoever may make such errors. No entry fee will be refunded in the event of such errors or cancellation of entries after the published closing date.
- NO REFUND FOR DUPLICATE ENTRIES. Every effort to find all duplicate entries will be made, however, no refund will be made if entry has been processed.
- RETURNED CHECKS & POST-DATED CHECKS do not constitute a valid entry fee. The SHOW SECRETARY will add a collection fee to the amount of each returned check. Sub-sequent returned checks from the same exhibitor will result in their being put on a cash basis.
- ACKNOWLEDGMENT of entries will be made as soon as is practical. Should such acknowledgment not be received by the exhibitor within a reasonable time, please notify the Show Secretary at 317-432-2149 or by email at: [MADAJ4@aol.com](mailto:MADAJ4@aol.com)
- NOTE: "Effective for all shows held on or after July 1, 1980, dogs which according to their owners' records have completed the requirements for a championship after the closing of entries for the show, but whose championships are unconfirmed, may be transferred from one of the regular classes to the Best of Breed competition, provided this transfer is made by the onsite Show Secretary at least one half-hour prior to the start of the regular conformation judging at the show (Chapter 11, Sec. 6, AKC Rules).

- THE SHOW SITE WILL BE AVAILABLE TO EXHIBITORS at discretion of the Show Committee, Saturday & Sunday, until 1 hour after all Judging ends.
- SHOW HOURS: As shown on the Judging Program. Consult Judging Program for time of judging. Dogs may arrive any time prior to their scheduled time of judging. Judges are not required to wait for dogs. The owner or handler of each dog is solely responsible for having it at ring-side when its classes are called to be judged. Dogs not required for further judging will be excused.
- ALL DOGS PRESENT MUST BE HELD ON A LEASH OR CONFINED TO THEIR CRATES except when being judged.